



ORPAZ

CAUTION! Do not adjust the platform or make any changes to it, while there is a firearm in the holster.



Molle



Paddle



Paddle Gen II



Belt Loop



Low Ride

ORPAZ M-SERIES - OWB INSTALLATION

1. Use an allen key to loosen the IWB Clip. Take off the back surface cover.

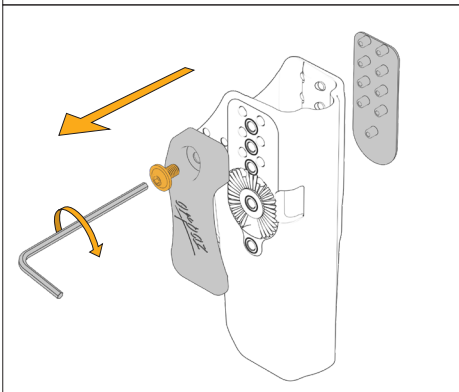

2. Take off the back surface cover. Attach it at the front - This will cover the front mounting inserts

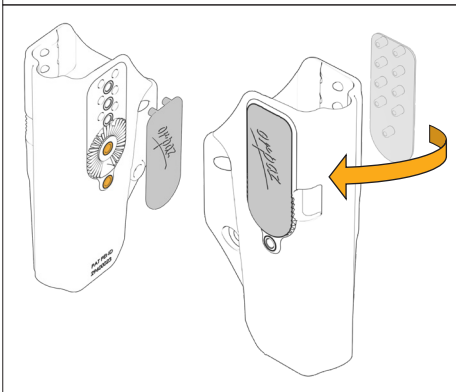

3. Align the holster mounting inserts with the holes on the attachment.

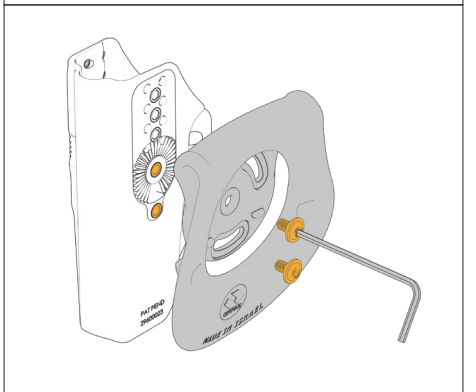

4. Adjust the rotation of the holster to your desired position. Then Firmly hand tighten the screws.

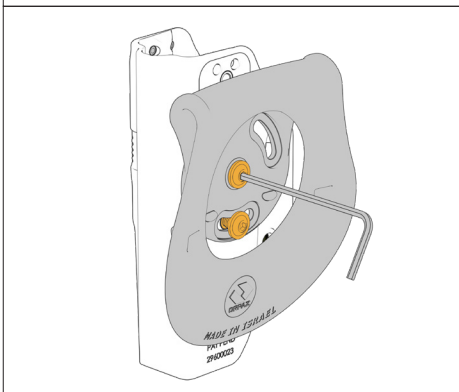

5. Use the retention screw to set the retention of the holster.

